

**For Information Contact:**

Bruce Jeffery  
 116 Route 22  
 North Plainfield, NJ 07060  
 Phone: 908 226-0123  
 Fax: 908 226-7426  
 E-Mail: [bjeffery@netproperties.us](mailto:bjeffery@netproperties.us)



**ELIZABETH, NEW JERSEY**  
**ROUTE 1 NORTH – (701 SPRING STREET)**

<b>Total GLA:</b>	28,000 Square Feet
<b>Available Sizes:</b>	1,311 Square Feet <b>End Cap</b> 1,726 Square Feet
<b>Availability:</b>	Immediate Availability
<b>Rental Rate:</b>	\$27.50 Per Square Foot
<b>Parking:</b>	50+ Cars
<b>Traffic Count:</b>	85,000 Cars Per Day
<b>NNN Charges:</b>	\$6.01 Per Square Foot
<b>Daytime Pop:</b>	424,670
<b>Frontage:</b>	275' on Route 1 North

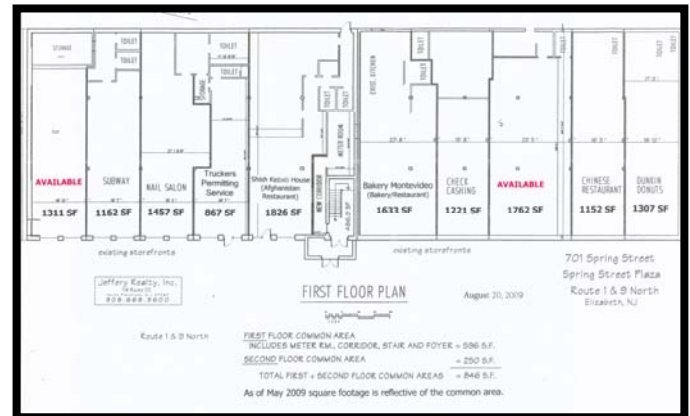

**Neighboring Retailers / Sites:** Newark Airport, Jersey Gardens Shopping Center, Daffy Dan's and Holiday Inn among others.

**Notes:** This very active center is located on Route 1, a heavily traveled corridor across NJ. site is adjacent Burger King and provides excellent demographics.

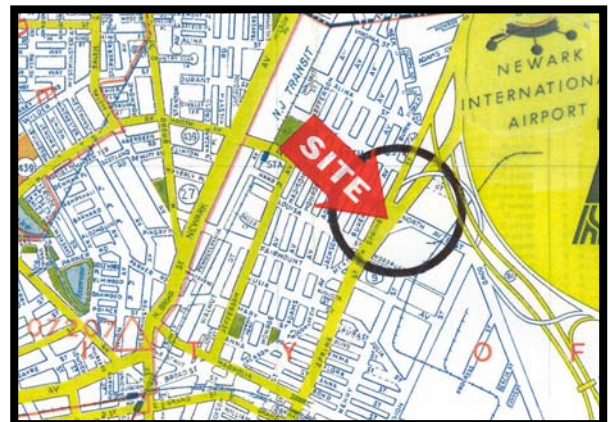

<b>Demographics:</b>	<b>1 Mile</b>	<b>3 Miles</b>	<b>5 Miles</b>
Population	25,107	189,349	562,216
Average HH Income	\$44,910	\$47,213	\$46,692

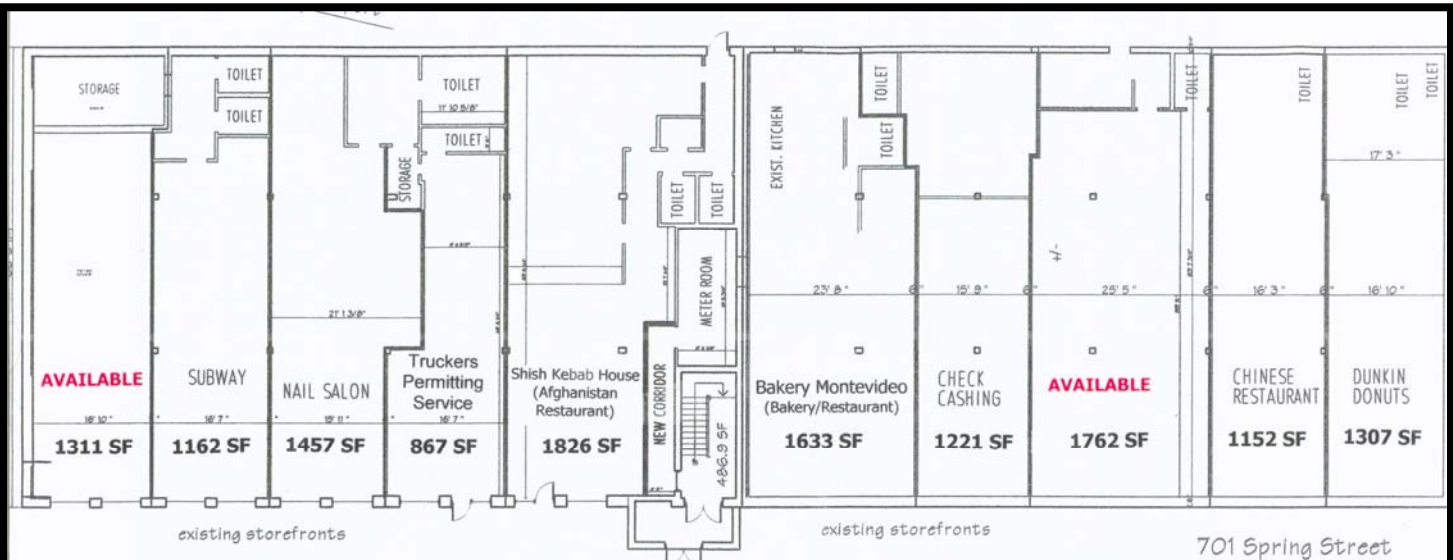

Jeffery Realty, Inc.  
 116 Route 22  
 North Plainfield, N.J. 07060  
 908.668.9600

**FIRST FLOOR PLAN**

August 20, 2009

701 Spring Street  
 Spring Street Plaza  
 Route 1 & 9 North  
 Elizabeth, NJ

Route 1 & 9 North

FIRST FLOOR COMMON AREA  
 INCLUDES METER RM., CORRIDOR, STAIR AND FOYER = 596 S.F.  
 SECOND FLOOR COMMON AREA = 250 S.F.  
 TOTAL FIRST + SECOND FLOOR COMMON AREAS = 846 S.F.

As of May 2009 square footage is reflective of the common area.



